

RESOLUTION NO. 15-2232

A RESOLUTION OF THE PLANNING COMMISSION OF THE CITY OF ARROYO GRANDE APPROVING CONDITIONAL USE PERMIT NO. 15-001 TO IMPLEMENT A STREAM GAUGE FISH PASSAGE IMPROVEMENT PROJECT FOR PROPERTY LOCATED WITHIN ARROYO GRANDE CREEK IN PROXIMITY TO CLARENCE AVENUE AND MYRTLE DRIVE (APN 007-572-029 AND 007-572-031), APPLIED FOR BY CENTRAL COAST SALMON ENHANCEMENT, INC. (CCSE)

WHEREAS, the Planning Commission of the City of Arroyo Grande has considered Conditional Use Permit No. 15-001, applied for by CCSE to modify an existing broad-crested concrete weir spanning the width of Arroyo Grande Creek; and

WHEREAS, funding for the project occurred through the 2014 Fisheries Restoration Grant Program (FRGP), which is administered by the California Department of Fish and Wildlife (CDFW); and

WHEREAS, FRGP was established in 1981 in response to rapidly declining populations of wild salmon and steelhead trout and deteriorating fish habitat in California; and

WHEREAS, CCSE applied for and received funding through FRGP to implement the proposed project which will lower the weir and restore reliable access to 3.3 miles of critical steelhead habitat upstream of the barrier; and

WHEREAS, the Planning Commission held a public hearing on this application on August 4, 2015 in accordance with City Code and found that the project is consistent with the General Plan and the environmental document associated therewith; and

WHEREAS, the State Water Resources Control Board (State Water Board) is the lead agency for determining adequate environmental review under the California Environmental Quality Act (CEQA) for the FRGP and adopted a Mitigated Negative Declaration (MND); and

WHEREAS, the Planning Commission has reviewed this project in compliance with CEQA and has determined that the MND prepared for FRGP is adequate for addressing environmental concerns for the stream gauge fish passage improvement project; and

WHEREAS, the Planning Commission finds after due study, deliberation and public hearing, the following circumstances exist:

Conditional Use Permit Findings:

1. The proposed use is permitted within the Public Facility zoning district pursuant to Development Code Section 16.44.040, and complies with all applicable provisions of the Development Code, the goals and objectives of the Arroyo Grande General Plan, and the development policies and standards of the City. Specifically, the

project is consistent with General Plan Objective C/OS2, which states: "Safeguard important environmental and sensitive biological resources contributing to healthy, functioning ecosystems." The Project is also consistent with General Plan Implementing Policy C/OS2-1.6: "Plan, design, and develop sites to: Protect scenic resources, water quality and natural creekside habitat, including opportunities for wildlife habitation, rest, and movement. Further the restoration of damaged or degraded habitat, especially where a continuous riparian habitat corridor can be established."

2. The proposed use will not impair the integrity and character of the district in which it is to be established or located due to the purpose and intent of the Public Facility district, which is to designate land for the conduct of public, quasi-public, and institutional activities, including the protection of areas needed for such future facilities. The project serves the public purpose of furthering the preservation of wild salmon, steelhead trout and other deteriorating fish habitat by removing a concrete barrier within Arroyo Grande Creek.
3. The site is suitable for the type and intensity of use that is proposed and will not result in any adverse impacts on adjacent land uses.
4. The use does not require the provision for water, sanitation, or public utilities and services and will not impact public health and safety.
5. The proposed use will not be detrimental to the public health, safety, or welfare, or materially injurious to properties and improvements in the vicinity. The proposed project is consistent with the Municipal Code and is conditioned to minimize potential noise impacts to the surrounding neighborhood.

NOW, THEREFORE, BE IT RESOLVED that the Planning Commission of the City of Arroyo Grande hereby approves Conditional Use Permit No. 15-001, with the above findings and subject to the conditions as set forth in Exhibit "A", attached hereto and incorporated herein by this reference.

On motion of Commissioner Mack, seconded by Commissioner Fowler-Payne, and on the following roll call vote, to wit:

AYES: Mack, Fowler-Payne and Martin
NOES: None
ABSENT: Keen, George

the foregoing Resolution was passed and adopted this 4th day of August, 2015.

ATTEST:

DEBBIE WEICHINGER
SECRETARY TO THE COMMISSION

GLENN MARTIN
COMMISSIONER

AS TO CONTENT:

TERESA MCCLISH
DIRECTOR OF COMMUNITY DEVELOPMENT

**EXHIBIT A
CONDITIONS OF APPROVAL
CONDITIONAL USE PERMIT NO. 15-001
CENTRAL COAST SALMON ENHANCEMENT, INC.
ARROYO GRANDE CREEK
STREAM GAUGE FISH PASSAGE IMPROVEMENT PROJECT**

COMMUNITY DEVELOPMENT DEPARTMENT

GENERAL CONDITIONS

This approval authorizes modifications to an existing broad-crested concrete weir spanning the width of Arroyo Grande Creek.

1. The applicant shall ascertain and comply with all Federal, State, County and City requirements as are applicable to this project.
2. The applicant shall comply with all conditions of approval for Conditional Use Permit No. 15-001.
3. This application shall automatically expire on August 4, 2017, unless an Encroachment Permit is issued. Thirty (30) days prior to the expiration of the approval, the applicant may apply for an extension of one (1) year from the original date of expiration.
4. Development shall occur in substantial conformance with the plans presented to the Planning Commission at the meeting of August 4, 2015 and marked Exhibit B.
5. To the full extent permitted by law, the applicant shall indemnify, defend and hold harmless the City, its agents, officers, and employees from and against any liability (including liability for claims, suits, actions, arbitration proceedings, administrative proceedings, regulatory proceedings, losses, expenses or costs of any kind, whether actual, alleged or threatened, including attorney's fees and costs, court costs, interest, defense costs, and expert witness fees), where the same arise out of, are a consequence of, or are in any way attributable to, in whole or in part, this Conditional Use Permit except liability arising out of the proven sole negligence of the City.

SPECIAL CONDITIONS

6. At least thirty (30) days prior to commencement of any earthmoving activities, the applicant shall notify all neighbors located within a 500' radius of the project area. The notification shall include information about the construction schedule and location of the staging area.
7. Prior to issuance of an Encroachment Permit, submit property owner authorization for staging and construction areas.

RESOLUTION NO. 15-2232**PAGE 5**

8. Construction activities shall be limited to 8:00 AM – 5:00 PM Monday through Friday (no construction on Saturdays or Sundays).
9. Noise control curtains shall be used to attenuate generator noise. Noise levels shall not exceed 45 decibels per Municipal Code Section 9.16.040.
10. The applicant shall implement all pertinent Mitigation Measures outlined in the Mitigated Negative Declaration prepared for the 2014 Fisheries Restoration Grant Program (FRGP) (on file in the Community Development Department).
11. The applicant shall implement the requirements outlined in the Technical Specifications for Arroyo Grande Fish Passage Improvement Project (on file in the Community Development Department).
12. The applicant shall implement the requirements outlined in the Clean Water Act Section 401 Water Quality Certification for the California Department of Fish and Wildlife 2014 Fisheries Restoration Grant Program (File No. SB14003IN) (on file in the Community Development Department).
13. The applicant shall implement the Re-vegetation Plan prepared for the project (on file in the Community Development Department).
14. The applicant shall submit evidence of obtaining permits from all resource agencies that have regulatory authority over this project.

ENGINEERING DIVISION

15. The applicant shall obtain a City of Arroyo Grande Encroachment Permit.
16. The applicant shall submit a Stormwater Pollution Prevention Plan/Erosion Control Plan prior to any earthmoving activities.
17. The applicant shall restore the site access area to pre-construction condition.
18. The applicant shall coordinate project work with the County Flood Control District.
19. The applicant shall submit a creek bypass plan, including any pumping requirements, pump hours of operation, pump storage, who to call with noise complaints, and the size of the pump.
20. A signature block shall be shown on the plans for City approval and for any other regulating agencies.

PUBLIC WORKS DEPARTMENT

21. A tree removal permit is required for any trees to be removed.

PREPARED AT THE REQUEST OF:
CENTRAL COAST SALMON ENHANCEMENT

- ATTN: STEPHANE WALD
10000 BOULEVARD
GROVER BEACH, CA 90403
2. THIS IS NOT A BROWNSHIP SPEC; PAVED LINES ARE NOT SHOWN HEREON. IT SHALL BE THE CLIENT'S RESPONSIBILITY TO DETERMINE AFFECTED PARCELS' OWNERSHIP AND OBTAIN ALL NECESSARY ASSESSMENTS FOR CONSTRUCTION.
3. THE ENGINEER SHALL BE NOTIFIED A MINIMUM OF 48 HOURS PRIOR TO COMMENCEMENT OF CONSTRUCTION.
4. ALL CONSTRUCTION AND MATERIALS SHALL CONFORM TO THE 2010 EDITION OF THE STATE OF CALIFORNIA STANDARD SPECIFICATIONS, ISSUED BY THE DEPARTMENT OF TRANSPORTATION (HEREAFTER REFERRED TO AS "STANDARD SPECIFICATIONS").
5. THESE PLANS ARE IN SUBSTANTIAL COMPLIANCE WITH ALL APPLICABLE STATE, LOCAL, AND OTHER LAWS GOVERNING THIS TYPE OF DEVELOPMENT.
6. EXISTING UNDERGROUND UTILITY LOCATIONS:

LOCATIONS SHOWN ARE COMPILED FROM INFORMATION SUPPLIED BY THE APPROPRIATE UTILITY AGENCIES AND FROM FIELD MEASUREMENTS TO ABOVE GROUND FEATURES READILY VISIBLE AT THE TIME OF SURVEY. LOCATIONS SHOWN ARE APPROXIMATE. THE CONTRACTOR IS CAUTIONED THAT ONLY ACTUAL EXCAVATION WILL REVEAL THE DIMENSIONS, SIZES, MATERIALS, LOCATIONS, AND DEPTHS OF INTERFERING UTILITIES.

THE CONTRACTOR SHALL BE SOLELY RESPONSIBLE FOR THE LOCATION AND/OR PROTECTION OF ALL EXISTING AND PROPOSED PAVING, UTILITIES, TRAFFIC SIGNAL EQUIPMENT (BOTH ABOVE GROUND AND BELOW GROUND), STRUCTURES, AND ALL OTHER EXISTING INFRASTRUCTURES THROUGHOUT CONSTRUCTION.

PRIOR TO COMMENCING FABRICATION OR CONSTRUCTION, CONTRACTOR SHALL DISCOVER OR VERIFY THE ACTUAL DIMENSIONS, LOCATIONS, DEPTHS, AND SPACING OF ALL EXISTING UTILITIES, TRAFFIC SIGNALS, AND OTHER INFRASTRUCTURES. CONTRACTOR SHALL BE RESPONSIBLE FOR OBTAINING ALL NECESSARY PERMITS AND RECORDS FROM THE CITY OF CHICAGO AND ANY OTHER AGENCIES. CONTRACTOR SHALL BE RESPONSIBLE FOR OBTAINING ALL NECESSARY PERMITS AND RECORDS FROM THE CITY OF CHICAGO AND ANY OTHER AGENCIES. CONTRACTOR SHALL BE RESPONSIBLE FOR OBTAINING ALL NECESSARY PERMITS AND RECORDS FROM THE CITY OF CHICAGO AND ANY OTHER AGENCIES.

CONTRACTOR SHALL TAKE APPROPRIATE MEASURES TO PROTECT EXISTING UTILITIES DURING CONSTRUCTION OPERATIONS, AND SHALL BE SOLELY RESPONSIBLE FOR THE PROTECTION OF EXISTING UTILITIES. CONTRACTOR SHALL BE RESPONSIBLE FOR THE PROTECTION OF EXISTING UTILITIES DURING CONSTRUCTION. CONTRACTOR TO CALL UNDERGROUND SERVICE ALERT (1-800-842-2444) TO LOCATE ALL UNDERGROUND UTILITY LINES PRIOR TO COMMENCING CONSTRUCTION.

UPON LEARNING OF THE EXISTENCE AND/OR LOCATIONS OF ANY UNDERGROUND FACILITIES NOT SHOWN OR INDICATED INACCURATELY ON THE PLANS OR NOT PROPERLY MARKED BY THE UTILITY OWNER, THE CONTRACTOR SHALL IMMEDIATELY

UTILITY RELOCATIONS REQUIRED FOR THE CONSTRUCTION OF THE PROJECT FACILITIES WILL BE PERFORMED BY THE UTILITY COMPANY, UNLESS OTHERWISE NOTED.

PRIOR TO BEGINNING WORK, THE CONTRACTOR SHALL CONTACT ALL UTILITIES COMPANIES WITH REGARD TO WORKING OVER, UNDER, OR AROUND EXISTING FACILITIES AND TO OBTAIN INFORMATION REGARDING RESTRICTIONS THAT ARE REQUIRED TO PREVENT DAMAGE TO THE FACILITIES.

SHOULD THE CONTRACTOR DISCOVER ANY DISCREPANCIES BETWEEN THE CONDITIONS EXISTING IN THE FIELD AND THE INFORMATION SHOWN ON THESE DRAWINGS, HE SHALL NOTIFY THE ENGINEER PRIOR TO PROCEEDING WITH CONSTRUCTION.

- [illegible]

PROJECT SCHEDULE. PRIOR TO COMMENCEMENT OF WORK, CONTRACTOR SHALL PROVIDE ENGINEER A DETAILED CONSTRUCTION SCHEDULE FOR APPROVAL. THE CONTRACTOR SHALL NOT BEGIN ANY CONSTRUCTION WORK UNTIL THE PROJECT SCHEDULE AND WORK PLAN IS APPROVED BY THE ENGINEER. ALL CONSTRUCTION SHALL BE CLOSELY COORDINATED WITH THE ENGINEER SO THAT THE QUALITY OF WORK CAN BE CHECKED FOR APPROVAL. THE CONTRACTOR SHALL PURSUE WORK IN A CONTINUOUS AND DILIGENT MANNER TO ENSURE A TIMELY COMPLETION OF THE PROJECT.

3. THE CONTRACTOR SHALL BE RESPONSIBLE FOR DESIGN, PERMITTING, INSTALLATION, AND MAINTENANCE OF ANY AND ALL TRAFFIC CONTROL MEASURES DEEMED NECESSARY.
- THE CONTRACTOR SHALL BE RESPONSIBLE FOR GENERAL SAFETY DURING CONSTRUCTION. ALL WORK SHALL CONFORM TO PERMITS, SAFETY REGULATIONS AND CODES. THE CONTRACTOR SHALL BE SOLELY AND COMPLETELY RESPONSIBLE FOR FURNISHING, INSTALLING, AND MAINTAINING ALL WARNING SIGNS AND DEVICES NECESSARY TO SAFEGUARD THE GENERAL PUBLIC AND THE WORK, AND PROVIDE FOR THE PROPER AND SAFE ROUTING OF VEHICULAR AND PEDESTRIAN TRAFFIC DURING THE CONSTRUCTION. THE CONTRACTOR SHALL BE RESPONSIBLE FOR THE PROTECTION OF ALL EXISTING UTILITIES AND ALL OTHER APPLICABLE PROVISIONS OF LAW IN THE CONSTRUCTION PROJECTS FOR ALL EXISTING AREAS. PROTECTIVE MEASURES SHALL BE

CONSTRUCTION CONTRACTOR AGREES THAT IN ACCORDANCE WITH GENERALLY ACCEPTED CONSTRUCTION PRACTICES, CONSTRUCTION CONTRACTOR WILL BE REQUIRED TO ISSUE SAFE AND COHERENT DISPOSITIONS TO THE CONTRACTOR'S EMPLOYEES AND TO THE PUBLIC IN THE CONSTRUCTION OF THIS PROJECT.

COURSE OF CONSTRUCTION OF THE PROJECT, INCLUDING SAFETY OF ALL PERSONS AND PROPERTY; THAT THIS REQUIREMENT SHALL BE MADE TO APPLY CONTINUOUSLY AND NOT LIMITED TO NORMAL WORKING HOURS; AND CONSTRUCTION CONTRACTOR FURTHER AGREES TO REFLECT, REDESIGN AND HOLD DESIGN RESPONSIBILITY, HARLESS FROM ANY AND ALL LIABILITY, REAL OR OTHERWISE, ARISING OUT OF THE COURSE OF CONSTRUCTION OF THE PROJECT, INCLUDING SAFETY OF ALL PERSONS AND PROPERTY, FROM THE SALE AND INSTALLATION OF THE PRODUCT, THROUGH THE PROCESS OF CONSTRUCTION, UNTIL THE PROJECT IS COMPLETED BY THE CONSULTANT OR HIS OR HER EMPLOYEES OR SUB-CONSULTANTS AT A CONSTRUCTION SITE SHALL RELY ON THE CONTRACTOR AND ITS SUBCONTRACTORS FOR THEIR RESPECTABLES INCLUDING, BUT NOT LIMITED TO, CONSTRUCTION MEANS, METHODS, MATERIALS, SEQUENCES OF OPERATION, SCHEDULING, SUPERINTENDING OR COORDINATING ALL PORTIONS OF THE WORK. REMEDIES OF ANY REGULATORY AGENCY NECESSARY FOR PERFORMING, SUPERINTENDING OR COORDINATING ALL PORTIONS OF THE WORK ARE RESERVED TO SUCH AGENCIES WITHOUT LIMITATION. THE CONTRACTOR SHALL MAINTAIN ALL RECORDS AND DOCUMENTS AND APPLICABLE HEALTH AND SAFETY REQUIREMENTS OF ANY REGULATORY AGENCY OR OF STATE LAW.

7. THE CONTRACTOR SHALL MAINTAIN A CURRENT, COMPLETE RECORD OF ALL AS-BUILT DEVIATIONS FROM THE CONSTRUCTION AS SHOWN ON THESE DRAWINGS AND SPECIFICATIONS FOR THE PURPOSE OF PROVIDING THE EXISTENCE RECORD WITH A BASIS FOR THE PREPARATION OF RECORD DRAWINGS.
8. THE CONTRACTOR SHALL BE RESPONSIBLE FOR MAINTAINING THE SITE IN A NEAT AND ORDERLY MANNER THROUGHOUT THE CONSTRUCTION PROCESS. ALL MATERIALS SHALL BE STORED WITHIN APPROVED STAGING AREAS.
9. THE CONTRACTOR SHALL BE RESPONSIBLE FOR OBTAINING AT HIS EXPENSE, ALL REQUIRED PERMITS NOT PREVIOUSLY OBTAINED FOR THE CONSTRUCTION OF THIS PROJECT. ALL MATERIALS, LABOR AND EQUIPMENT REQUIRED TO COMPLY WITH ALL APPLICABLE PERMIT CONDITIONS AND REQUIREMENTS.

1. CONTRACTOR SHALL BE RESPONSIBLE FOR ALL CONSTRUCTION STAKING AND LAYOUT, UNLESS OTHERWISE SPECIFIED.

1. THE CONTRACTOR SHALL BE RESPONSIBLE FOR THE PROTECTION AND PRESERVATION OF ALL SURVEY MONUMENTS OR PROPERTY OWNERS' MONUMENTS THAT ARE LOCATED WITHIN THE PROJECT LIMITS. MONUMENTS SHALL BE IDENTIFIED BY THE REGISTERED CIVIL ENGINEER OR LAND SURVEYOR AT THE EXPENSE OF THE CONTRACTOR.
2. THE CONTRACTOR IS REQUIRED TO ASSUME SOLE AND COMPLETE RESPONSIBILITY FOR JOB SITE CONDITIONS DURING THE COURSE OF CONSTRUCTION OF THE PROJECT, INCLUDING SAFETY OF ALL PERSONS AND PROPERTY; THAT THIS REQUIREMENT SHALL BE MADE TO APPLY CONTINUOUSLY AND NOT BE LIMITED TO NORMAL WORKING HOURS.
3. THE CONTRACTOR SHALL CONFORM TO THE RULES AND REGULATIONS OF THE CONSTRUCTION SAFETY ORDERS OF THE STATE DIVISION OF OCCUPATIONAL SAFETY AND HEALTH PERTAINING TO EXCAVATION AND TRENCHES PER SECTION 7 OF THE STANDARD

1) GRADING SUMMARY:
TOTAL CUT VOLUME = 93 CY

- THE ABOVE QUANTITIES ARE APPROXIMATE IN-PLACE VOLUMES CALCULATED AS THE DIFFERENCE BETWEEN EXISTING GROUND AND THE PROPOSED FINISH GRADE, PREPARED FOR PERMITTING PURPOSES ONLY. EXISTING GROUND IS DEFINED BY THE TOPOGRAPHIC CONTOURS AND/OR SPOT ELEVATIONS ON THE PLAN. PROPOSED FINISH GRADE IS DEFINED AS THE DESIGN SURFACE ELEVATION OF WORK TO BE CONSTRUCTED. THE QUANTITIES HAVE NOT BEEN REQUIRED TO INCLUDE ALLOWANCES FOR BUILDING, CLEANING AND GRUBBING, OR FOR THE REMOVAL OF EXISTING STRUCTURES, OR FOR UNDERGROUND UTILITY AND SUBSTRUCTURE SPILLS AND CONSTRUCTION.

METHODS.

3. PRIOR TO COMMENCING WORK, ALL AREAS TO REMAIN UNDISTURBED SHALL BE ADEQUATELY PROTECTED WITH TEMPORARY FENCING.

4. DO NOT DISTURB AREAS OUTSIDE OF THE DESIGNATED LIMITS OF THE EXISTING EASEMENT AUTHORIZED IN WRITING BY THE ENGINEER. ALL WORK ASSOCIATED WITH ANY DISTURBANCE OF AREAS OUTSIDE THE DESIGNATED LIMITS OF DISTURBANCE AS SHOWN ON THE DRAWINGS, SHALL BE BORNE SOLELY BY THE CONTRACTOR.
5. ALL EXISTING SOILS SHALL BE REMOVED TO AN APPROVED DUMP SITE OR TO ANOTHER LOCATION APPROVED BY THE ENGINEER. SOILS REMOVED IN A MANNER THAT WILL NOT CAUSE FROSTING.

6. CLEARING AND GRUBBING, SUBGRADE PREPARATION AND EARTHWORK SHALL BE PERFORMED IN ACCORDANCE WITH SECTION 19 OF THE STANDARD SPECIFICATIONS FOR PUBLIC WORKS, LATEST EDITION.

7. UNSUITABLE SOIL OR MATERIALS, NOT TO BE INCLUDED IN THE WORK SPECIFICATIONS, THESE DRAWINGS, AND THE TECHNICAL SPECIFICATIONS, INCLUDE:

A. ORGANIC MATERIALS SUCH AS PEAT, LIGNITE, OR COAL

INCHES.

A. MATERIAL WHICH WILL NOT ACHIEVE SPECIFIED DENSITY OBTAINING
F. POORLY GRADED COURSE MATERIAL, PARTICLE SIZE IN EXCESS OF 8
D. MATERIAL CONTAINING EXCESSIVE MOISTURE.
C. SOILS CONTAINING EXPANSIVE CLAYS.
B. MATERIALS CONTAINING EXCESSIVE MOISTURE.
A. MATERIALS CONTAINING EXCESSIVE MOISTURE.

8. FINE GRADING ELEVATIONS AND SLOPES NOT SHOWN SHALL BE DETERMINED BY THE CONTRACTOR IN THE FIELD TO OBTAIN DRAINAGE IN THE DIRECTION INDICATED. ALL FINAL ELEVATIONS SHALL BE WITHIN 20% TOLERANCE. SEE PAGE 101-3.04.

1) REVEGETATION AND REPLACEMENT PLANTINGS SHALL CONSIST OF LOGICALLY-OBTAINED, NATIVE SPECIES THAT ARE ECOLOGICALLY APPROPRIATE TO THE SITE.

- 2) STAGING AND STORAGE AREAS FOR EQUIPMENT, MATERIALS, FUELS, LUBRICANTS AND SOLVENTS, SHALL BE LOCATED OUTSIDE OF THE STREAM AND CHANNEL BANKS. STATIONARY EQUIPMENT SUCH AS MOTORS, PUMPS, GENERATORS, COMPRESSORS, AND WELDERS, LOCATED WITHIN OR ADJACENT TO THE STREAM SHALL BE POSITIONED OVER DIRT PANS. ANY EQUIPMENT OR VEHICLE DRIVEN AND/OR OPERATED WITHIN OR ADJACENT TO THE STREAM SHALL BE POSITIONED DOWNSTREAM OF ANY DOWNSTREAM LEAKS OR MATERIALS THAT IF INTRODUCED TO WATER COULD BE DETERMINED TO BE A HAZARD TO THE STREAM. VEHICLES SHALL BE MOVED AWAY FROM THE STREAM PRIOR TO REFUELING AND LUBRICATION.

- 3) WASH WATER CONTAINING MUD OR SILT FROM AGGREGATE WASHING OR OTHER OPERATIONS SHALL NOT BE ALLOWED TO ENTER THE STREAM CHANNEL.
- 4) NO DEBRIS, RUBBISH, CREOSOTE-TREATED WOOD, SOIL, SILT, SAND, CEMENT,

- CONCRETE, OR WASHINGS OR OTHER CONSTRUCTION-RELATED MATERIALS OR WASTES, OIL, OR PETROLEUM PRODUCTS OR OTHER ORGANIC MATERIALS OR EARTHEN MATERIAL SHALL BE ALLOWED TO ENTER INTO, OR BE WASHED OR RINSED, OR WASHED BY RAINFALL OR RUNOFF DOWNSTREAM. ALL SUCH MATERIALS SHALL BE REMOVED IMMEDIATELY WHEN CONSTRUCTION IS COMPLETE. ANY EXCESS MATERIAL SHALL BE REMOVED FROM THE WORK AREA SO THAT SUCH MATERIALS DO NOT CUMULATIVE IN THE CREEK, DURING CONSTRUCTION. THE CONTRACTOR SHALL NOT CUMULATIVE ANY LITTER OR CONSTRUCTION DEBRIS WITHIN THE RIPARIAN/STREAM ZONE. ALL SUCH DEBRIS AND WASTE SHALL BE PICKED UP DAILY AND PROPERLY DISPOSED OF AT AN APPROPRIATE SITE.

- 5) NO EQUIPMENT SHALL BE OPERATED IN AREAS OF FLOWING OR STANDING WATER; NO FUELING, CLEANING OR MAINTENANCE OF VEHICLES OR EQUIPMENT SHALL TAKE PLACE WITHIN ANY AREAS WHERE AN ACCIDENTAL DISCHARGE TO THE CREEK MAY OCCUR; CONSTRUCTION MATERIAL AND HEAVY EQUIPMENT MUST BE STORED OUTSIDE OF THE ORDINARY HIGH WATER MARK.

1) PEDESTRIAN ACCESS SHALL BE LIMITED TO THE EXISTING STAIRWAY AND
EARTH.

- 2) ACCESS PATH SHOWN ON SHEET C4 SHALL BE UTILIZED BY SPIDER HOE FOR INGRESS/EGRESS ONLY. ACCESS SHALL BE LIMITED TO ONE ROUND TRIP, WEATHER PERMITTING.
- 3) WASTE CONCRETE AND ROCK SHALL BE REMOVED TO STAGING AREA EITHER BY LONG-REACH EXCAVATOR, CRANE OR MANUAL LABOR, TO MINIMIZE DISTURBANCE TO STREAMBANK.

- 4) FOLLOWING CONSTRUCTION, ACCESS PATH SHALL BE RESTORED TO PRE-CONSTRUCTION CONDITIONS, AS DIRECTED BY THE ENGINEER. RESTORATION SHALL INCLUDE, BUT NOT BE LIMITED TO, RESTORING GRADES, SEEDING, APPLYING SLOPE PROTECTION FABRIC, AND REPLACEMENT OF DISTURBED VEGETATION WITH APPROPRIATE NATIVE SPECIES.

1) PRIOR TO COMMENCING WORK, ALL AREAS TO REMAIN UNDISTURBED SHALL BE ADEQUATELY PROTECTED WITH TEMPORARY FENCING, TYPE ESA.

2) ALL DISTURBED AREAS ARE TO BE SEEDED WITH THE FOLLOWING MIX AT THE FOLLOWING RATES:

[illegible]

- 7) FOLLOWING SEEDING, BROADCAST STRAW MULCH, FREE OF NON-NATIVE SEEDS, AT THE RATE OF 2000 POUNDS PER ACRE TO AREAS THAT HAVE BEEN SEEDING AND WHERE SLOPES ARE LESS THAN 5%. WHERE SLOPES EXCEED 5%, SLOPE PROTECTION FABRIC SHALL BE APPLIED OVER SEEDING AREAS.

- 1) BETWEEN OCTOBER 15 AND APRIL 15, EXPOSED SOIL SHALL BE PROTECTED FROM EROSION AT ALL TIMES. DURING CONSTRUCTION, SUCH PROTECTION MAY CONSIST OF MULCHING AND/OR PLANTING OF NATIVE VEGETATION OF ADEQUATE DENSITY. BEFORE COMPLETION OF THE PROJECT, ANY EXPOSED SOIL ON DISTURBED SLOPES SHALL BE PERMANENTLY PROTECTED FROM EROSION.

- 1) THE CONTRACTOR SHALL INCORPORATE ADEQUATE DRAINAGE PROCEDURES DURING THE CONSTRUCTION PROCESS TO ELIMINATE EXCESSIVE PONDING AND PROSOM

- 3) ADEQUATE EROSION CONTROL MEASURES SHALL BE CONSTRUCTED AND MAINTAINED TO PREVENT THE DISCHARGE OF EARTHEN MATERIALS TO THE STREAM FROM DISTURBED AREAS UNDER CONSTRUCTION AND FROM COMPLETED CONSTRUCTION AREAS. ALL DISTURBED AREAS OF BED AND BANK SHALL BE RESTABILIZED, WINTERIZED, AND VEGETATED WITH APPROPRIATE NATIVE VEGETATION PRIOR TO THE END OF THE WORK WINDOW.

PRIOR TO COMMENCEMENT OF WORK, CONTRACTOR SHALL PROVIDE ENGINEER WITH DETAILED CONSTRUCTION SCHEDULE FOR APPROVAL. THE CONTRACTOR SHALL NOT BEGIN ANY CONSTRUCTION WORK UNTIL THE PROJECT SCHEDULE AND WORK PLAN IS APPROVED BY THE ENGINEER. ALL CONSTRUCTION SHALL BE CLOSELY COORDINATED WITH THE ENGINEER SO THAT THE QUALITY OF WORK CAN BE CHECKED FOR APPROVAL. THE CONTRACTOR SHALL PURSUE WORK IN A THOROUGH AND DILIGENT MANNER TO ENSURE A TIMELY COMPLETION OF CONSTRUCTION PHASING SHALL BE GENERALLY COMPLETED IN THE FOLLOWING ORDER:

- 1) INSTALL BARS.
- 2) ESTABLISH ACCESS AND EQUIPMENT STAGING AREAS.
- 3) CALL FOR PERSONNEL.
- 4) INSTALL PERSONNEL, REMOVAL OF THE STATE AND REMOVE ANY REMAINING FISH (BY QUALIFIED BIOLOGIST).
- 5) PERFORM CLEANING AND GRUBBING.
- 6) DEMOLISH CONCRETE.
- 7) EXCAVATE BEDROCK.
- 8) EXCAVATE BEDROCK AND EXPLORATORY TRENCH.
- 9) PLACE CONCRETE.
- 10) ALLOW CONCRETE TO CURE.
- 11) INSTALL CAUSE.
- 12) RESTORE DISTURBED AREAS.
- 13) RECOVER AND RELOCATE FISH.
- 14) RECOVER AND RELOCATE DISTURBED AREAS.

PREPARED AT THE REQUEST OF:
CENTRAL COAST
SALMON ENHANCEMENT

100% SUBMITTAL
IMPROVEMENT PROJECT
FISH PASSAGE
ARROYO GRANDE GAGE

DESIGNED BY: MHW	2
DRAWN BY: BAS	OF
CHECKED BY: MHW	6
DATE: 01-15-09	
JOB NO.: 07-580	
BAR IS ONE INCH ON ORIGINAL DRAWING. ADJUST SCALES FOR REDUCED PLOTS 0	

REV.	DATE	DESCRIPTION	BY
Δ	2/15/11	RESPONSE TO AGENCY COMMENTS	B.M.S.
Δ	1/6/15	NO CHANGES THIS SHEET	B.M.S.

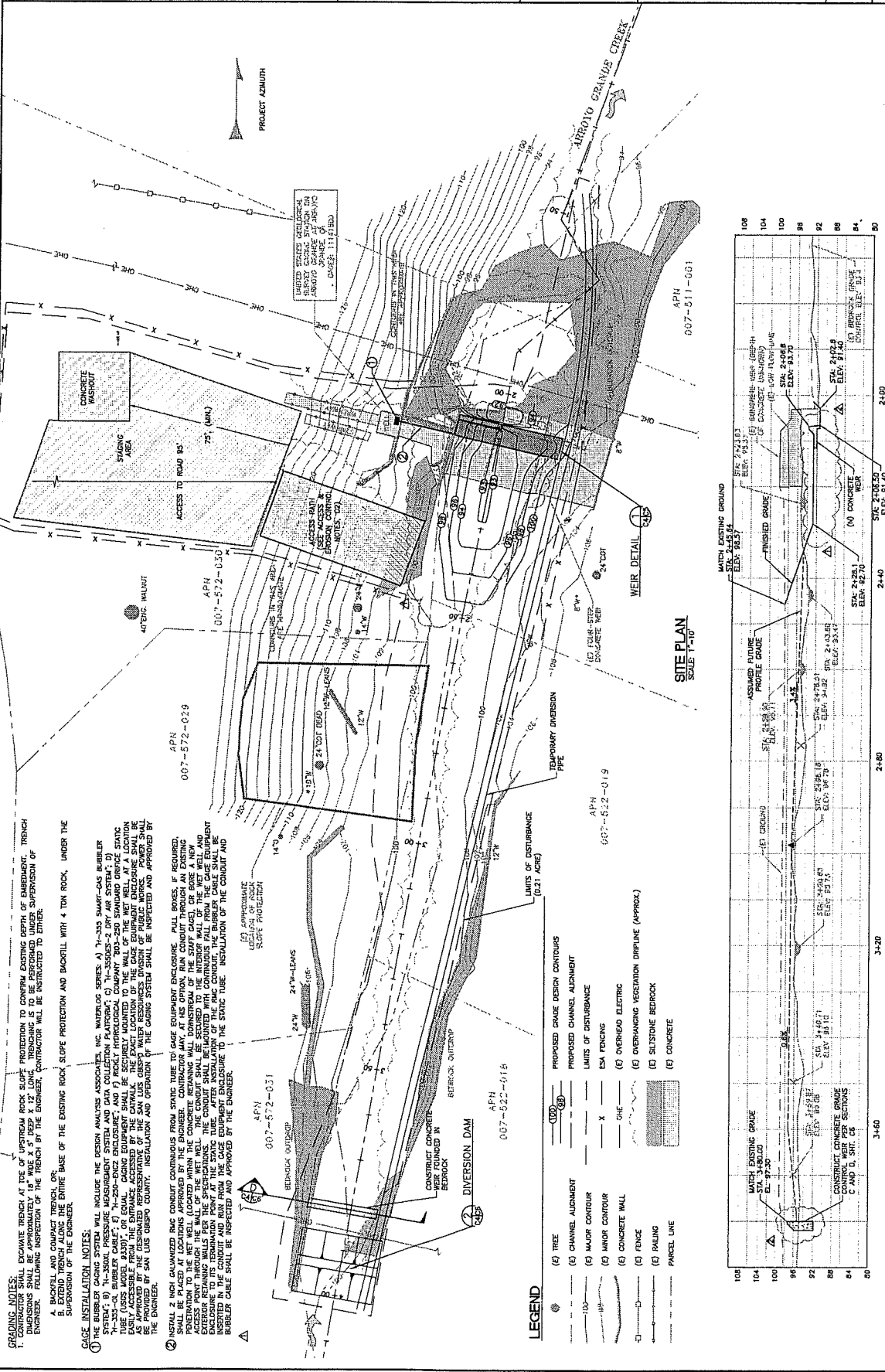

CONCRETE NOTES:
1. EXCAVATE TRENCH AT THE OF UPSTREAM ROCK SLOPE PROTECTION TO CONFORM EXISTING GROUND. TRENCH DIMENSIONS SHALL BE APPROXIMATELY 18\"/>

GAUGE INSTALLATION NOTES:
1. INSTALL 2\"/>

LEGEND:
(E) TREE
(E) CHANNEL ALIGNMENT
(E) MAJOR CONTOUR
(E) MINOR CONTOUR
(E) CONCRETE WALL
(E) FENCE
(E) RAILING
(E) PARCEL LINE
(E) PROPOSED GRADE DESIGN CONTOURS
(E) PROPOSED CHANNEL ALIGNMENT
(E) LIMITS OF DISTURBANCE
(E) ERM FENCING
(E) OVERHEAD ELECTRIC
(E) OVERHANGING VEGETATION DRIPLINE (APPROX.)
(E) SILTSTONE BEDROCK
(E) CONCRETE

REVISIONS:
1. 1/6/15: 100% SUBMITTAL
2. 1/6/15: 100% SUBMITTAL

PROJECT INFORMATION:
PROJECT: ARROYO GRANDE GAGE IMPROVEMENT PROJECT
LOCATION: CENTRAL COAST, CALIFORNIA
CLIENT: CENTRAL COAST SALMON ENHANCEMENT

DESIGNER:
WATERWAYS CONSULTING INC.
5024 SWIFT ST.
SAVANNAH, GA 31406
WWW.WATERWAYS.COM

DATE:
1/6/15

PROJECT:
ARROYO GRANDE GAGE IMPROVEMENT PROJECT

SCALE:
SITE PLAN: 1\"/>

CHANNEL PROFILE:
SCALE: 1\"/>

LEGEND:
--- EXISTING GROUND
--- APPROXIMATE EXISTING BEDROCK PROFILE
--- ASSUMED FUTURE PROFILE GRADE

REVISIONS:
1. 1/6/15: 100% SUBMITTAL
2. 1/6/15: 100% SUBMITTAL

PROJECT INFORMATION:
PROJECT: ARROYO GRANDE GAGE IMPROVEMENT PROJECT
LOCATION: CENTRAL COAST, CALIFORNIA
CLIENT: CENTRAL COAST SALMON ENHANCEMENT

DESIGNER:
WATERWAYS CONSULTING INC.
5024 SWIFT ST.
SAVANNAH, GA 31406
WWW.WATERWAYS.COM

DATE:
1/6/15

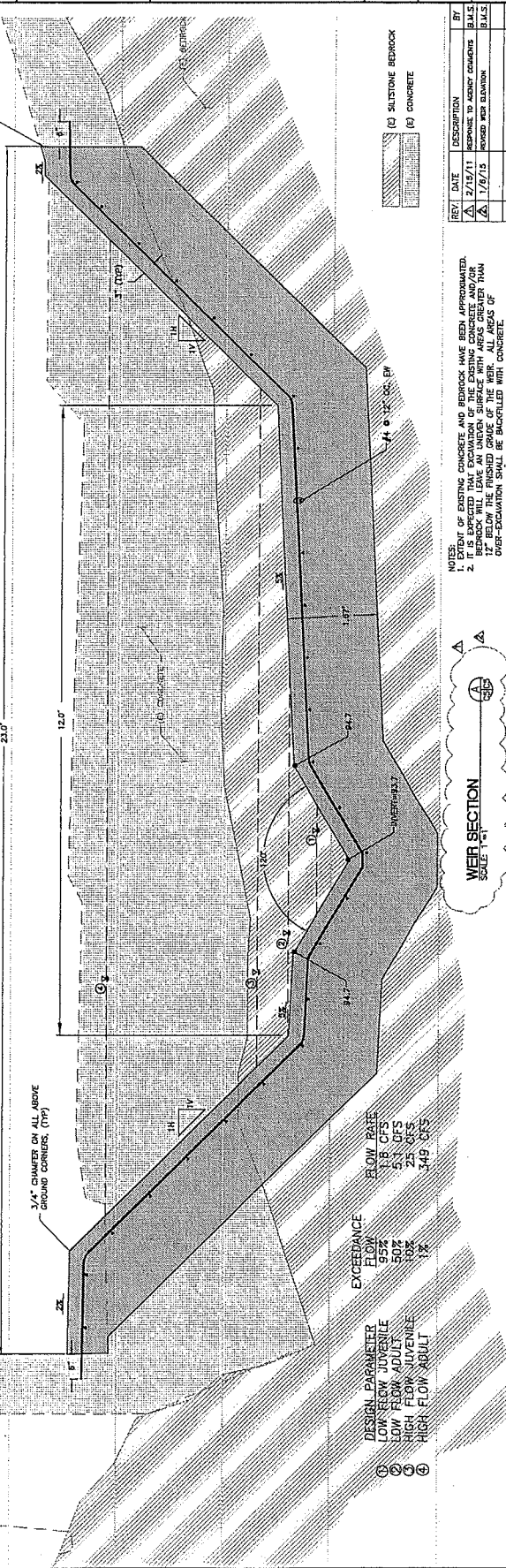
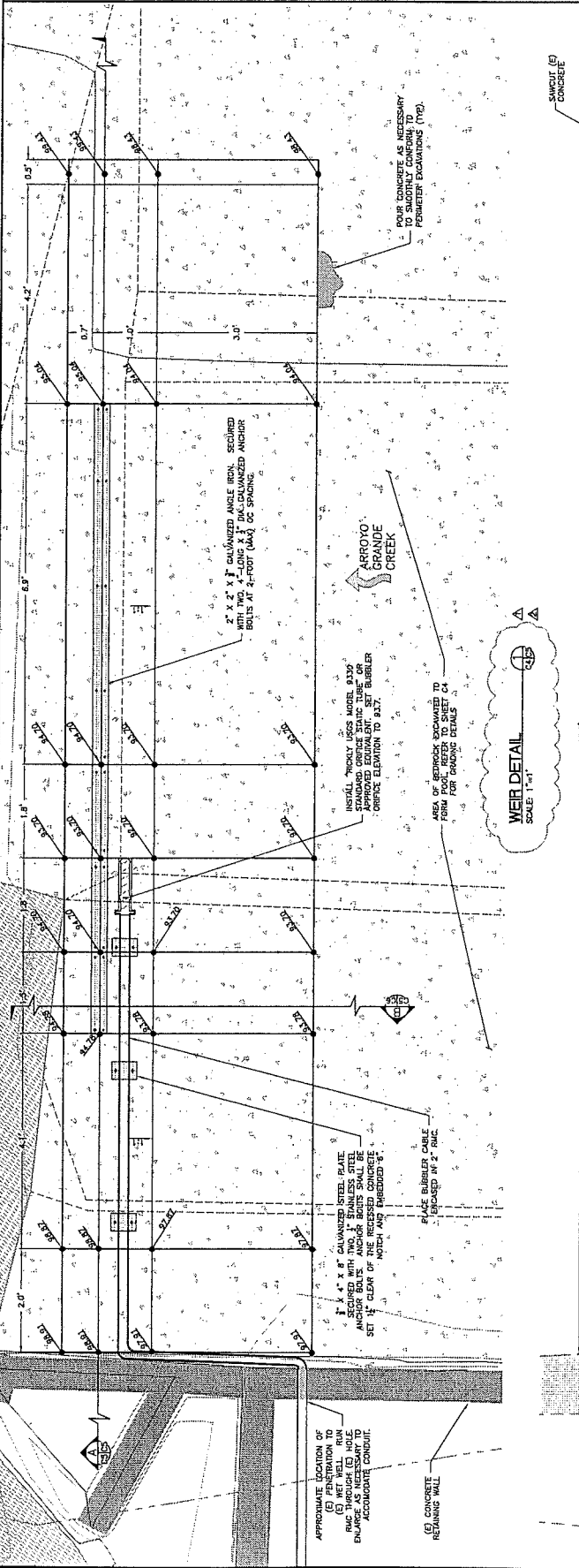

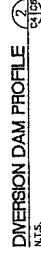
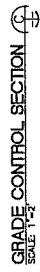
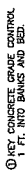

NOTE: CONTRACTOR MAY USE ALTERNATE DAM DETAIL, SUBJECT TO APPROVAL OF THE ENGINEER AND THE PERMITTING AGENCIES.